



DESCRIPTION

6" Architectural frame-in kits combined with LED module and integral reflector. This is designed for use in non-insulated ceiling. Insulation material must be kept a minimum of 3" from fixture. Provided in high efficacy LED with dimmable driver and the special optical diffusion allows high lumen transmission and light uniformity.

DESIGN FEATURES

LED MODULE & TRIM

- Aluminum extruded Heat sink designed to facilitate heat dissipation to reduce LED junction temperature for maintaining constant light output, color and life of solid state components.
- Module construction includes LED, heat sink and lens.
- Heavy gauge aluminum reflector anodized in clear, haze, gold, champagne and pewter color finish. Reflectors may provide with black and white milled groove baffle collar.

MOUNTING RING

- 20-gauge CRS mounting ring, black-painted. 1-5/8" deep collar may use for various thickness of ceiling materials.

Junction Box

- Listed for through branch circuit wiring. (Max.8 No 12 AWG 90 °C branch circuit conductors. (4 in, 4 out)
- (5)1/2" knockouts with true pry-out slots and (4) knockouts with Romex cable clamp.
- Ground wire provided on J-box.

MOUNTING CHANNEL BRACKET

- Commercial mounting kit provided up to 5" vertical adjustment, which accommodates 1/2" EMT conduit, optional HB-24 or HBC-24 bar hanger or lathing channels for T-bar grid or concealed spline ceiling.

LED POWER SUPPLY DRIVER

- 120~277V input high efficacy drivers with the capability to dim by a Triac 120V low voltage electronic dimmer switches by 0-10V dimmer switches.
- Driver feature power factor >.90, THD <20% and has integral thermal protection to sense over temperature or internal failure.
- Driver mounts externally to the module, allowing future replacement, if needed.
- Consult with factory for optional 0~10V analog dimmable driver.

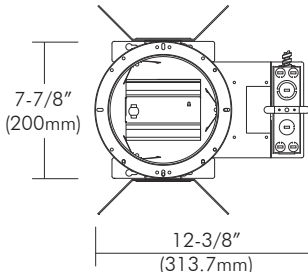
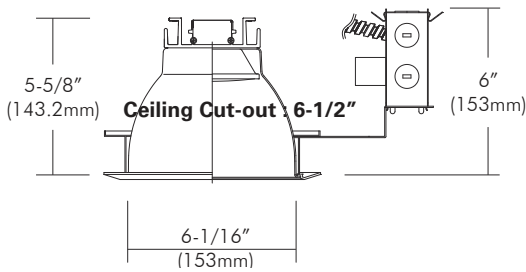

SPECIFICATIONS

LED Quantity	1 ea (COB)			
Input Voltage	120-277V AC			
Wattage (+/-5%)	14W	23W	30W	45W
Lumens (+/-5%)	947	1573	2078	2886
Efficacy (LPW)	67.6	68.4	69.3	65.3
Beam Angle	75°	75°	75°	75°
Color (+/-5%)	3000K, 3500K, 4000K			
CRI (Typical)	80			
Dimming	Triac (Standard), 0-10V			
Rated	up to 50,000 hr			
Environment	Damp & Wet Location			

Easy Quick Connector Case

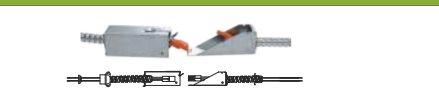

Triac Approved Dimmers

- * Lutron: NovaT (Ntelv 300&600) Diva (Dvelv-300P&303P)
- * Leviton: Acenti: Ate06-1LW
- * Leviton Trimatron #705W (incandescent)

0-10V Approved Dimmers

- * Lutron: Nova 0-10V : NTFTV Diva 0-10V : DVTV
 - * Leviton: Decora 0-10V : IP710DL
- Consult tech, service or factory for additional dimmers**

Options

- Emergency battery back-up : Available in mounted to fixture or remote adjacent to luminaire (consult with factory for exact application).

Warranty

- 50,000 hr lamp life

Listing ETL & cETL Listed.

-State of California Title 24

-Energy star Approved & Listed

HOUSING COMPATABILITY FOR ZL-LED-ARFK RETROFIT

ZL-LED-ARFK6 ETL Listed for installation in the following architectural housings;

- 6" : FH-VC6, FH-VA6, FH-VAR6, FH-HC6, FH-HA6, FH-HAR6, IH-VF6150, IH-VA6150, IH-VAR6150, IH-HA6150, IH-HAR6150 MH-VF6, MH-VA6, MH-VAR6, Mh-HF6, MH-HA6, MH-HAR6

ZL-LED-ARFK6 ETL Classified for retrofit in the following 6" architectural housing;

- Halo : PD6V142E, PD6V120, PD6V501E, PD6V701E, PD6V1001E
- Juno : CV6-118T, CV6-126Q, CV6-126/32T, TC906, MX6-(50,70,100), M6-(70,100)
- Lithonia : LP6F, CCR62, LP6H, LP6, LV



PHOTOMETRIC REPORT * Contact Factory for IES File

*All trims are rated for damp location and regressed lens trims are wet location listed.

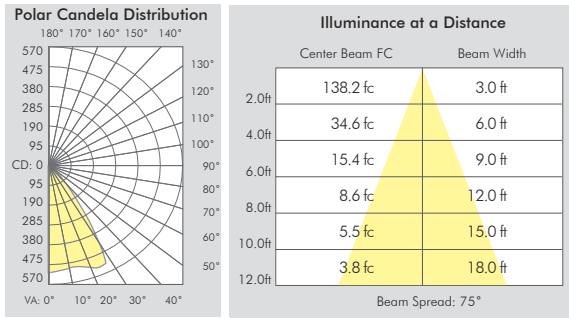

[LED-ARFK6-14] [LEDH-CFK6-14] [LEDH-AFK6-14] [LEDH-RFK6-14]

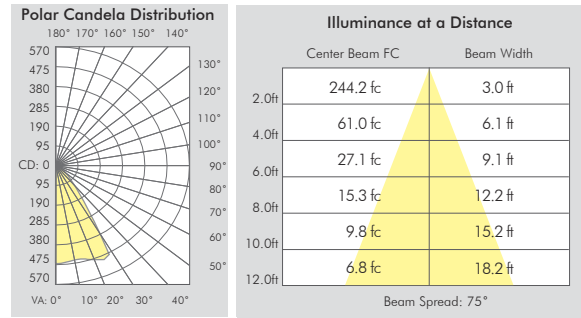

[LED-ARFK6-23] [LEDH-CFK6-23] [LEDH-AFK6-23] [LEDH-RFK6-23]

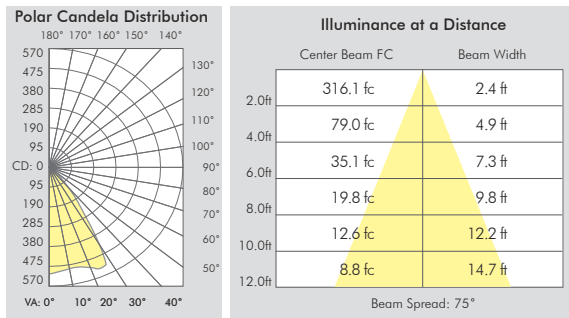

[LED-ARFK6-30] [LEDH-CFK6-30] [LEDH-AFK6-30] [LEDH-RFK6-30]

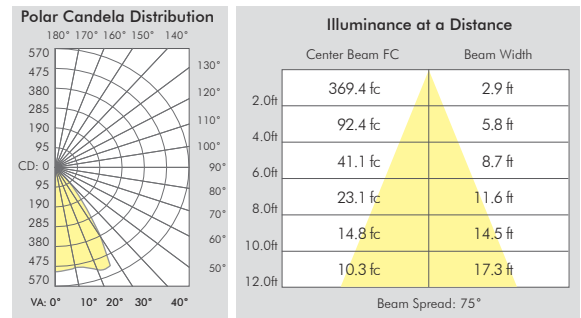

[LED-ARFK6-45] [LEDH-CFK6-45] [LEDH-AFK6-45] [LEDH-RFK6-45]

Housing	Watts	Color temp	Driver	Trim	Reflector	Baffle Finish	Optional Metal Trim Ring
ZL-LED-ARFK6	-14 : 14W	-30 : 3000K	-UT D : 120~277V, Triac Dimming (Standard) (14W,23W&30W only)	-LEDT-R64	-HC : haze clear	-WH : White	-BLANK : White Plastic Ring (Standard)
ZL-LEDH-CFK6	-23 : 23W	-35 : 3500K	-UZTD : 120~277V, 0~10V Dimming	-LEDT-R614	-WH : white painted	- B K : Black	-WH : white
ZL-LEDH-AFK6	-30 : 30W	-40 : 4000K	*Option	-LEDT-R641	*Consult with factory for custom finishes		- S N : satin nickel
ZL-LEDH-RFK6	-45 : 45W		-EM : Emergency battery backup	-LEDT-R622			- C H : chrome
				-LEDT-R636			- S F : Self flange
				-LEDT-R640			